



01912E00

Tank Inspection Lights Series 6122

- For use in Zones 1, 2, 21 and 22
- For halogen lamps 5 W to 100 W
- Mounting options
 - Tilting hinge
 - Mounting bracket
 - Flange collar
- Corrosion-resistant light metal enclosure
- Glass cover
 - Temperature resistant borosilicate glass or
 - Anti-dazzle opal glass
- Connection options
 - Potted connection lead
 - Connection chamber

Series 6122 tank inspection lights are suitable for the illumination of storage tanks, stirring tanks, distillation columns, pipeline flow indicators etc.

Zones 1 & 2, 21 & 22

Selection Table							
Version	Lamp wattage	Lamp-holder	Temperature class at $T_a = 40\text{ °C}$	$T_{O\text{ max.}}$ at $T_a = 40\text{ °C}$	Rated voltage	Order number	Weight kg
Size 1 with flexible lead	5 W	G 4	T6	80 °C	12 V AC / DC ¹⁾	6122/2-02-005-012-0	1,750
					24 V AC	6122/2-02-005-024-0	2,250
					36 V AC	6122/2-02-005-036-0	2,250
					42 V AC	6122/2-02-005-042-0	2,250
					115 V AC	6122/2-02-005-115-0	2,250
					230 V AC	6122/2-02-005-230-0	2,250
					240 V AC	6122/2-02-005-240-0	2,250
	10 W	G 4	T4	130 °C	12 V AC / DC ¹⁾	6122/2-02-010-012-0	1,750
					24 V AC	6122/2-02-010-024-0	2,250
					36 V AC	6122/2-02-010-036-0	2,250
					42 V AC	6122/2-02-010-042-0	2,250
					115 V AC	6122/2-02-010-115-0	2,250
					230 V AC	6122/2-02-010-230-0	2,250
					240 V AC	6122/2-02-010-240-0	2,250
	20 W	G 4	T4	130 °C	12 V AC / DC ¹⁾	6122/2-02-020-012-0	1,750
					24 V AC	6122/2-02-020-024-0	1,780
					36 V AC	6122/2-02-020-036-0	2,250
					42 V AC	6122/2-02-020-042-0	2,250
					115 V AC	6122/2-02-020-115-0	2,250
					230 V AC	6122/2-02-020-230-0	2,250
					240 V AC	6122/2-02-020-240-0	2,250
Size 1 with connection chamber	5 W	G 4	T6	80 °C	12 V AC / DC ¹⁾	6122/2-12-005-012-0	1,650
					24 V AC	6122/2-12-005-024-0	2,150
					36 V AC	6122/2-12-005-036-0	2,150
					42 V AC	6122/2-12-005-042-0	2,150
					115 V AC	6122/2-12-005-115-0	2,150
					230 V AC	6122/2-12-005-230-0	2,150
					240 V AC	6122/2-12-005-240-0	2,150
Add. to ordering code							
Text to order:	<ul style="list-style-type: none"> • Reflector-halogen lamp unit wide beam „flood“, (standard: concentrated beam „spot“) • Housing painted with 2-component epoxy paint • Opal glass cover 						
Note	Tank inspection lights are supplied without lamps and mounting material. These parts must be ordered separately. ¹⁾ without transformer - direct connection						

Selection Table							
Version	Lamp wattage	Lampholder	Temperature class at $T_a = 40\text{ °C}$	$T_{O\text{ max.}}$ at $T_a = 40\text{ °C}$	Rated voltage	Order number	Weight kg
Size 1 with connection chamber	10 W	G 4	T4	130 °C	12 V AC / DC ¹⁾	6122/2-12-010-012-0	1,650
					24 V AC	6122/2-12-010-024-0	2,150
					36 V AC	6122/2-12-010-036-0	2,150
					42 V AC	6122/2-12-010-042-0	2,150
					115 V AC	6122/2-12-010-115-0	2,150
					230 V AC	6122/2-12-010-230-0	2,150
					240 V AC	6122/2-12-010-240-0	2,150
	20 W	G 4	T4	130 °C	12 V AC / DC ¹⁾	6122/2-12-020-012-0	1,650
					24 V AC	6122/2-12-020-024-0	1,640
					36 V AC	6122/2-12-020-036-0	2,150
					42 V AC	6122/2-12-020-042-0	2,150
					115 V AC	6122/2-12-020-115-0	2,150
					230 V AC	6122/2-12-020-230-0	2,160
					240 V AC	6122/2-12-020-240-0	2,150
	50 W	G 6.35	T3	195 °C	12 V AC / DC ¹⁾	6122/2-12-050-012-0	1,650
24 V AC / DC ¹⁾					6122/2-12-050-024-0	1,800	
Size 2 with connection chamber	20 W	G 4	T6	80 °C	12 V AC / DC ¹⁾	6122/4-12-020-012-0	2,650
					24 V AC / DC ¹⁾	6122/4-12-020-024-0	2,650
					24 V AC	6122/4-12-020-024-0/T	3,600
					36 V AC	6122/4-12-020-036-0	3,600
					42 V AC	6122/4-12-020-042-0	3,600
					115 V AC	6122/4-12-020-115-0	3,600
					230 V AC	6122/4-12-020-230-0	3,600
	240 V AC	6122/4-12-020-240-0	3,600				
	50 W	G 6.35	T4	130 °C	24 V AC	6122/4-12-050-024/T	3,600
					36 V AC	6122/4-12-050-036-0	3,600
Size 3 with connection chamber	100 W	G 6.35	T4	130 °C	12 V AC / DC ¹⁾	6122/6-12-100-012	6,700
					24 V AC / DC ¹⁾	6122/6-12-100-024-0	6,700
Add. to ordering code							
Text to order:	<ul style="list-style-type: none"> • Reflector-halogen lamp unit wide beam „flood“, (standard: concentrated beam „spot“) • Housing painted with 2-component epoxy paint • Opal glass cover 						
Note	Tank inspection lights are supplied without lamps and mounting material. These parts must be ordered separately. ¹⁾ without transformer - direct connection						

Mounting options

Mounting options for size 1 and 2
6122/2 and 6122/4

Mounting on sight glasses

to DIN 28120 or similar: NW 25-NW 150: with tilting hinge (from NW 125 anti-dazzle shield must be included in order) NW 80-NW 200: with mounting bracket

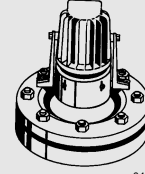

04983e00

Tilting hinge and anti-dazzle shield

Mounting on flow indicators with bracket or customer specified fixing

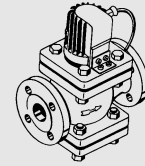

04984e00

Mounting bracket

Mounting on screwed sight glasses

to DIN 11 851 (Milkpipe screw fixing gland) NW 65-NW 100: by means of intermediate flange collar material 1.4301 from NW 125: Mounting bracket on grooved collar nut



05366e00

Intermediate flange collar

Mounting options for size 3
6122/6

Mounting on sight glasses

to DIN 28 120 or similar: NW 100-NW 200: with tilting hinge NW 100-NW 200: with foot ring

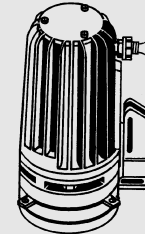

05367e00

Tilting hinge

Dimension drawings (all dimension in mm) - subject to alteration

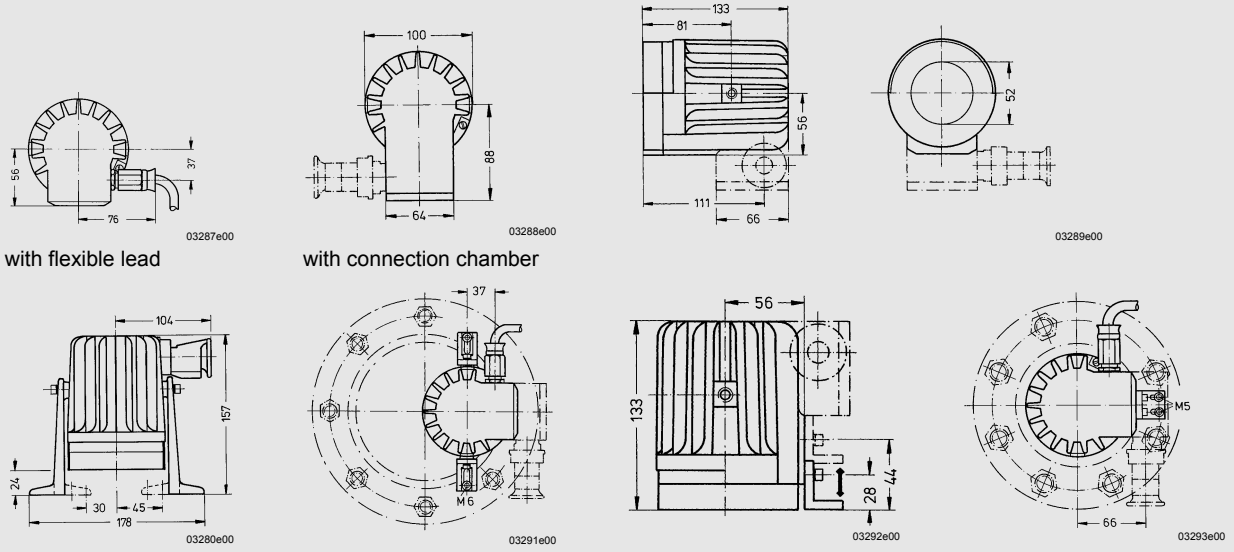

with flexible lead

with connection chamber

Fixing with tilting hinge
Tank inspection lights, 6122/2 up to 50 W (size 1)

Fixing with mounting bracket

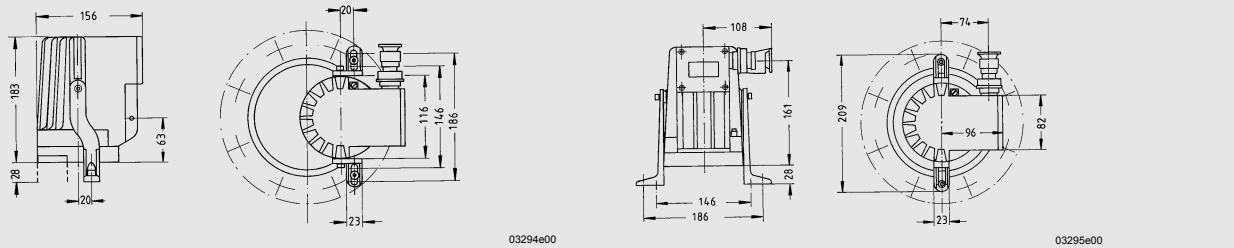

Fixing with tilting hinge

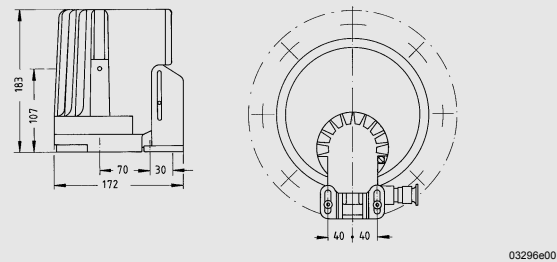

Fixing with tilting hinge
Tank inspection lights, 6122/4, 50 W (size 2)

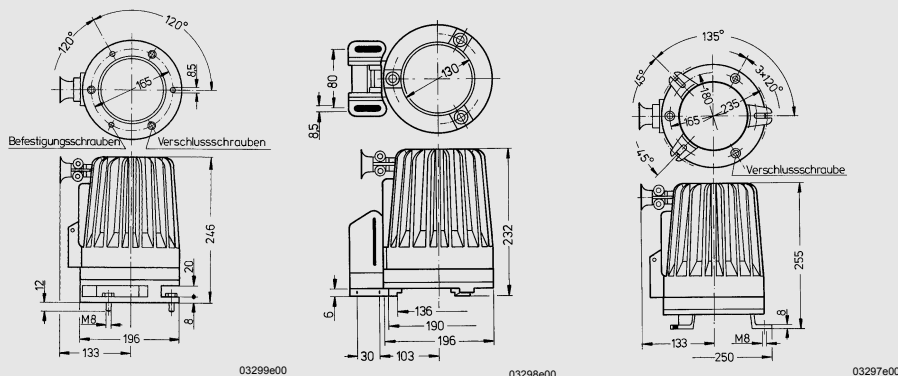

Flange fixing

Tilting hinge fixing

Foot ring fixing

Tank inspection lights, 6122/6, 100 W (size 3)

We reserve the right to make alterations to the technical data, weights, dimensions, designs and products available without notice. The illustrations cannot be considered binding.