



01713E00

Diode Indicating Lamps for Panel Mounting Series 8013

- Explosion protection to
 - CENELEC
 - IEC
- For use in
 - Zone 1 and Zone 2
 - Zone 21 and Zone 22
- Colours:
red, yellow, green, blue, white
- High luminance
- Low heat built-up
- Very long life
- Cage clamp
in the connection area

STAHL



The indicating lamps Series 8013 signal command modes in load, control and signal circuits by lighting up or going out. They are designed for single-hole fixing D 30 to EN 50 007 in combination with indicating lamp inserts Series 8602.

Indicating lamp Types 8013/..1 are complete explosion-protected electrical devices. They are suitable for mounting in panels, covers of electrical devices and switch-boards. Types 8013/..2 are incomplete explosion protected devices and only suitable for mounting in enclosures of protection „Increased safety“ acc. to EN 50 019.





Indicating lamps type 8013/..2. are „intrinsically safe“ and are used in intrinsically safe circuits.

Zones 1 & 2, 21 & 22

Selection Table

Version	Description	Order number	Weight kg
 8013/3.1 with connection area	connection: cage clamp	Ex e 8013/311-al	0,130
	connection: cage clamp	Ex i 8013/321-al	0,140
 8013/3.2 without connection area	connection: cage clamp	Ex e 8013/312-al	0,100
	connection: cage clamp	Ex i 8013/322-al	0,110
Note	The coloured caps red, yellow, green, blue, white added in packing. Diode indicating lamp with installed connection cable on request		



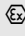

Technical Data

Explosion protection			
Gas explosion protection	Ex e	8013/311  II 2 G Ex de mb IIC T6 8013/312  II 2 G Ex de mb IIC	
	Ex i	8013/321  II 2 G Ex d mb ia IIC T6 8013/322  II 2 G Ex d mb ia IIC	
Dust explosion protection	 II 2 D Ex tD A21 IP 65 T80 °C		
Certificates	8013/3.1	PTB 02 ATEX 2131 X	
	8013/3.2	PTB 02 ATEX 2130 U	
Other certificates	UL (USA), CSA (Canada)		
Ambient temperature	- 30 °C ... + 60 °C		
Rated voltage	Ex e	12 V - 10 % ... 254 V + 6 % AC / DC	
	Ex i	10.8 V ... 28 V DC	
Rated current	0.014 A at 24 V DC		
Frequency	0 Hz ... 60 Hz		
Rated power	0.6 W		
Colours	red, yellow, green, blue, white Colour filtering via coloured insert caps		
Connection type	Connection cross-section: 8013/3.1 0.75 mm ² ... 1.5 mm ² 8013/3.2 0.50 mm ² ... 2.5 mm ²		
Cable entry	Type 8013/3.1: M 16 x 1.5 (∅ 4 - 9 mm)		
Ingress protection	Degree of protection acc. to IEC 60529 8013/3.1 IP 66 8013/3.2 IP 66 / IP 20 (connections)		
Electrical life	10 ⁵ lighting hours		
Material	Polyamide		
	Additional electrical data for intrinsically safe version type 8013/3.2		
Safety maximum values	U _i 28 V, I _i 150 mA, P _i 1 W, inductivity L _i and capacity C _i negligible		
Binary output	STAHL 9175/10-16-11	one duct	
	STAHL 9175/20-16-11	two ducts	
Safety barrier	STAHL 9001/01-280-110-101		



Diode Indicating Lamps for Panel Mounting Series 8013

Accessories and Spare Parts

Designation	Illustration	Description	Order number	Weight kg
Additional front label	 05543E00	Label mount, size 1, without insertable label Text: 1 line	8602904800	0,002
		Label mount, size 2, without insertable label Text: 1 or 2 lines	8602907800	0,003
		Label mount, size 3, without insertable label Text: 1, 2 or 3 lines	8602920800	0,004
		for actuator inserts to fit standard \varnothing 30.5 mm holes Symbol labels: without text with text; please specify text HAND - 0 - AUTO I - 0 - II OFF - • - ON 0 - I - II 0 - I 0 - Operation - I I - II 0 - • - I		
Calotte	 05038E00	round, \varnothing 30.5 mm, with transparent lens	8602912580	0,015
Cap	 05039E00	red	8602920580	0,001
		yellow	8602919580	0,001
		green	8602921580	0,001
		blue	8602922580	0,001
		white	8602918580	0,001
		all colours	8602806580	0,005
Closing part	 05647E00	to close not used mounting holes \varnothing 30.5 mm	8602801587	0,016

STAHL

Dimensional Drawings (All Dimensions in mm) - Subject to Alterations

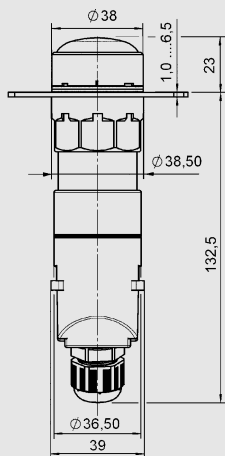

8013/3.1 and 8013/3.3
Indicating lamp
with terminal compartment

03314E00

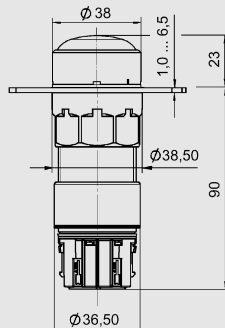

8013/3.2
Indicating lamp
without terminal compartment

04825E00

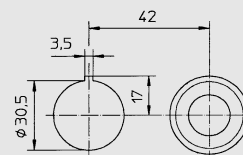

Cut-out for aligning several devices
 \varnothing 38 mm in a panel

04488E00

We reserve the right to make alterations to the technical data, weights, dimensions, designs and products available without notice. The illustrations cannot be considered binding.